

3. Low Pressure Valve Plate Assembly - Model 2545

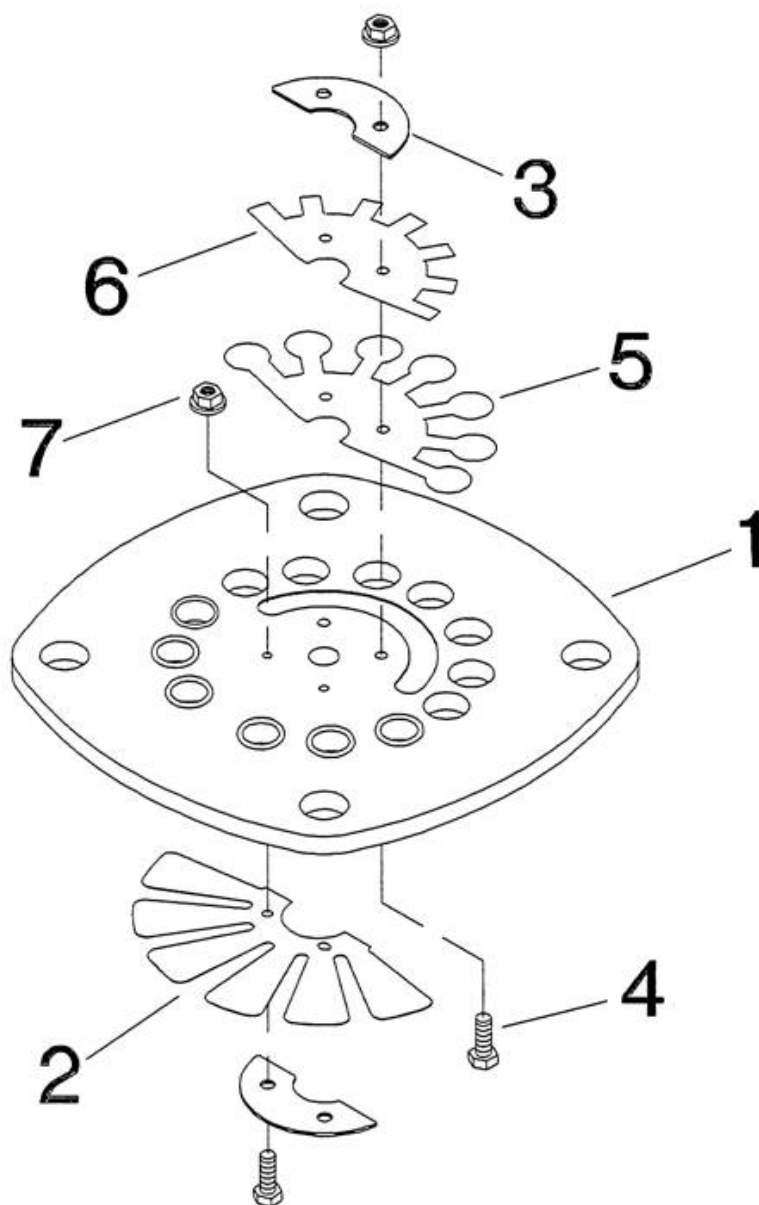

All manufacturer's names, numbers, photos, product description and/or part numbers are used for reference purposes only & it is not implied that any part listed is the product of these manufacturers. Since Approvement are made from time to time, the illustration and specifications are subject to change without notice.

3. Low Pressure Valve Plate Assembly - Model 2545

REF. NO.	PART NO.	DESCRIPTION	QTY.	SPARES		
				1	2	3
REF.	32293912	ASSEMBLY, LOW PRESSURE (5") VALVE PLATE	1			
3-1	32294274	PLATE, LOW PRESSURE VALVE	1			
3-2	32294324	VALVE, LOW PRESSURE INTAKE FINGER	1			
3-3	32294340	RETAINER, LOW PRESSURE INTAKE & DISCHARGE VALVES	2			
3-4	32247512	SCREW, M4X12 HEX HEAD	4			
3-5	32294332	VALVE, LOW PRESSURE DISCHARGE FINGER	1			
3-6	32294365	DAMPER, LOW PRESSURE DISCHARGE VALVE	1			
3-7	32248171	NUT, M4 HEX	4			

All manufacturer's names, numbers, photos, product description and/or part numbers are used for reference purposes only & it is not implied that any part listed is the product of these manufacturers. Since Approvement are made from time to time, the illustration and specifications are subject to change without notice.